



ASSEMBLY INSTRUCTIONS (ROOF RAIL)
Product Code: MR01072 (Crown)

COMPATIBLE VEHICLES
JP RNGD (BU) SUV 15-

FIRST TIME INSTALLATION

- * REMOVE PARTS FROM INSIDE THE PACKAGE AND CHECK THEM ALL
- * CONTACT YOUR DEALER IF ANY PART IS MISSING OR DAMAGED
- * USE THE EQUIPMENT SPECIFIED FOR INSTALLATION

PACKAGE INCLUDED

| | |
|---------------------------|---|
| 1- PLASTIC STOPPLE | 4 |
| 2- M6x40 INBUS BOLT (5Nm) | 2 |
| 3- M6x55 INBUS BOLT (5Nm) | 2 |
| 4- M6 WASHER | 4 |
| 5- 5mm ALLEN WRENCH | 1 |

ZIPLOCK BAG

1 Araç tavanındaki plastikleri sökünüz.
Remove the plastics from vehicle's roof.

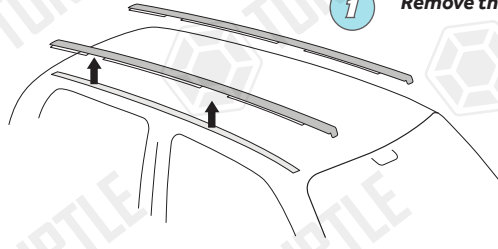

Şekilde gösterilen bağlantı noktalarına karşılık gelecek şekilde tavadan söktüğünüz plastiği 8mm çapında deliniz.

2 Drill the plastic you removed from the vehicle's roof with a diameter of 8 mm, corresponding to the connection points shown in the figure.

Plastik parçayı tavadan söktüğünüz yerine tekrar takınız.

3 Reinstall the plastic part where you removed it from the vehicle's roof.

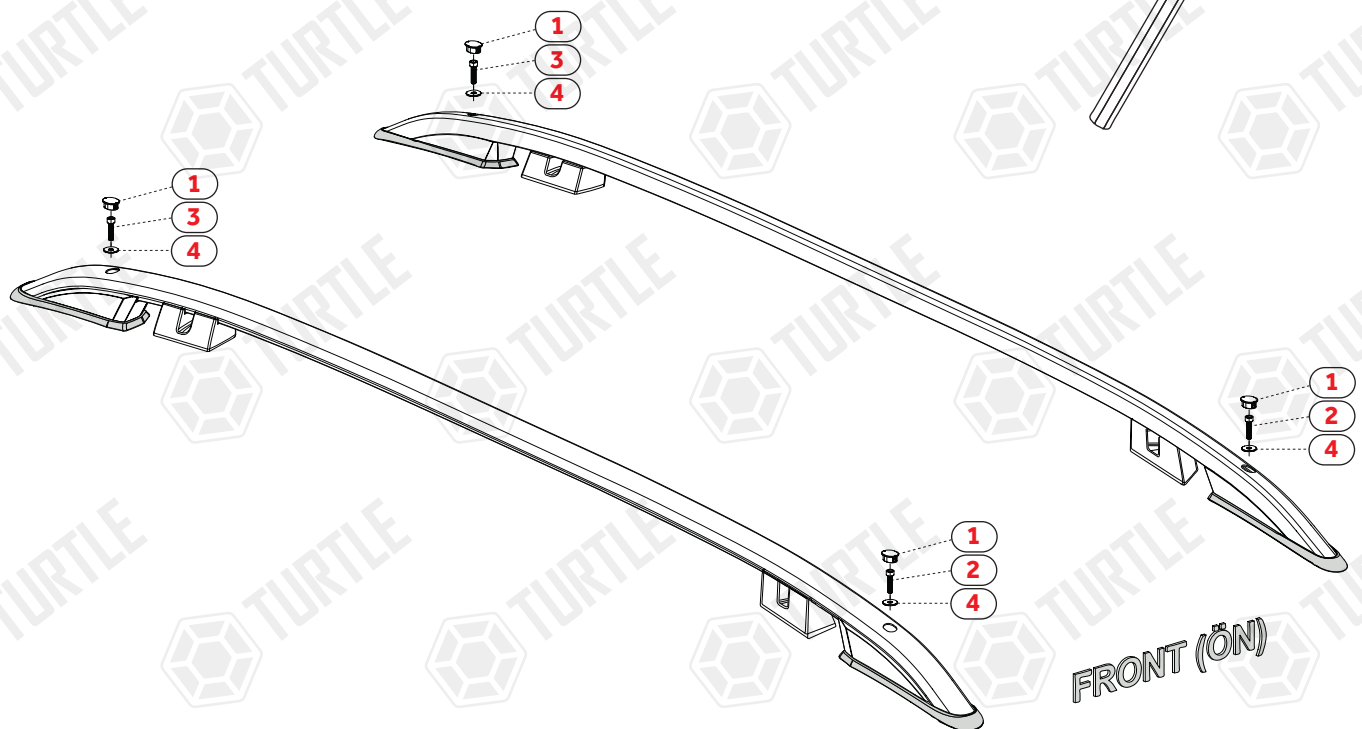
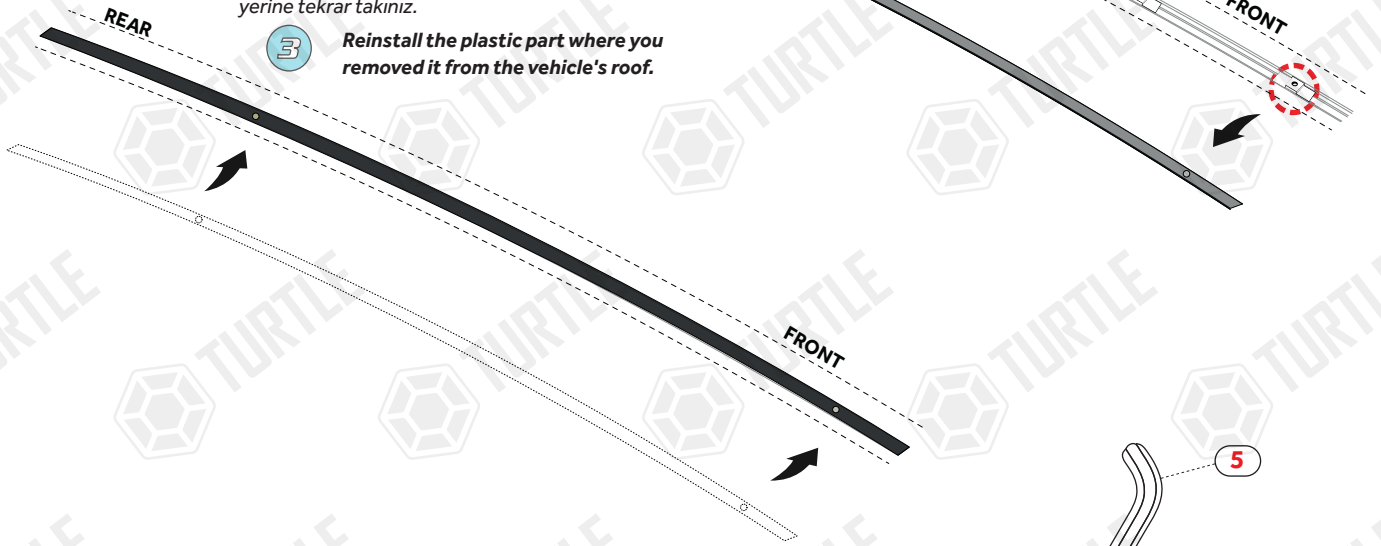

FRONT (ÖN)

MR01072 / Rev.03 /08.12.2022 (ECE)